



Cedar Hill St

SCRUBBER PAD AREA

UNDERGROUND
BIOGAS PIPING

Suburban Propane

Simarano Dr

Concord Electric
Supply Marlborough

D'Angelo Dr

Flexible Business Systems

Ken's Foods Inc.,
Corporate Headquarters

Linde

Averca Discovery

- NOTES:
1. SEE DRAWINGS S-001 AND S-002 FOR STRUCTURAL NOTES.
 2. SEE DRAWING S-002 FOR SITE PLAN
 3. CONTRACTOR TO FIELD-VERIFY ALL DIMENSIONS PRIOR TO FABRICATION AND CONSTRUCTION.
 4. EXTENTS OF ROADWAY ARE DENOTED BY DIAGONAL HATCHING.

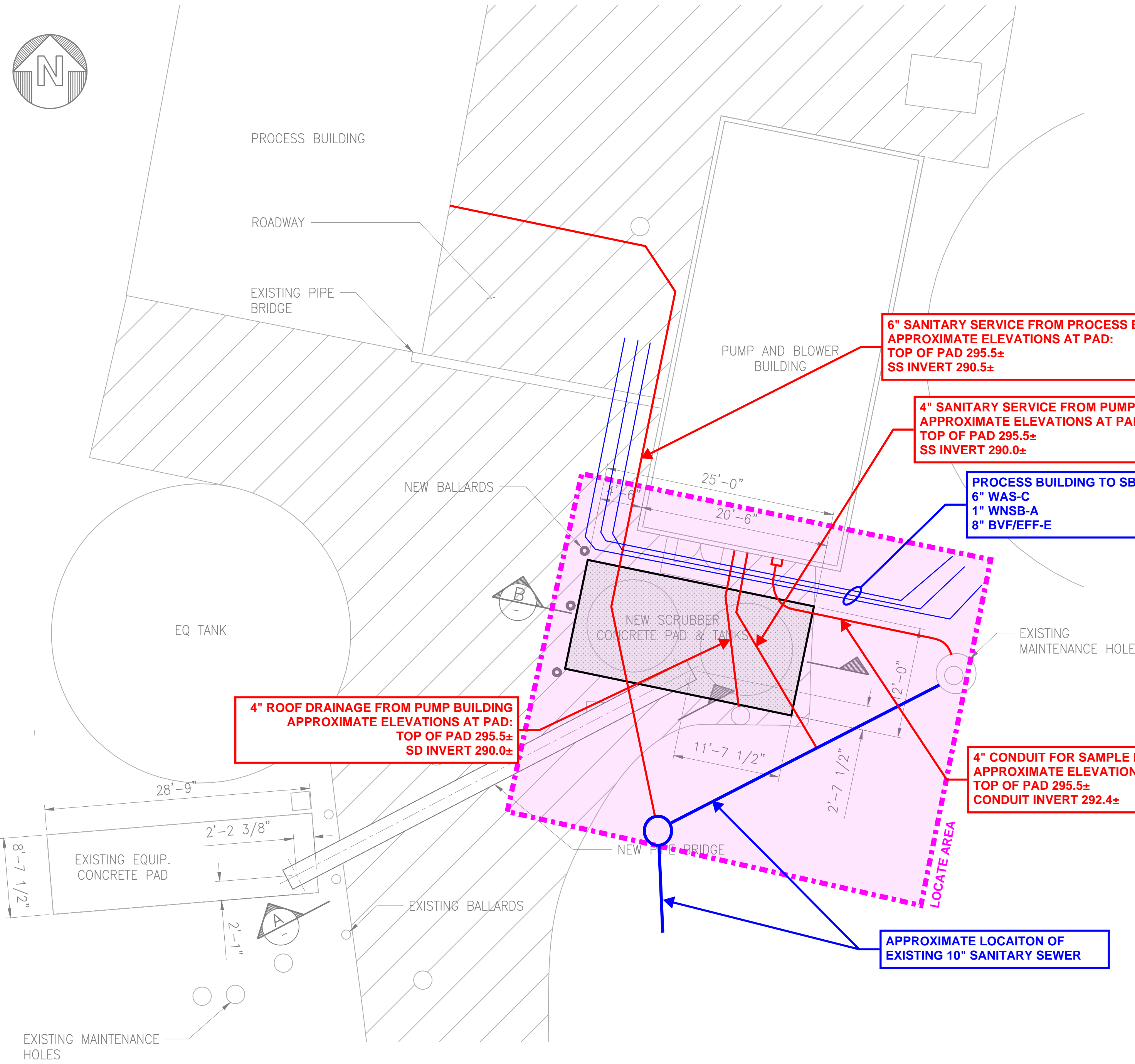

SCRUBBER TANK AND PIPE BRIDGE PLAN
SCALE: 1/8"=1'-0"

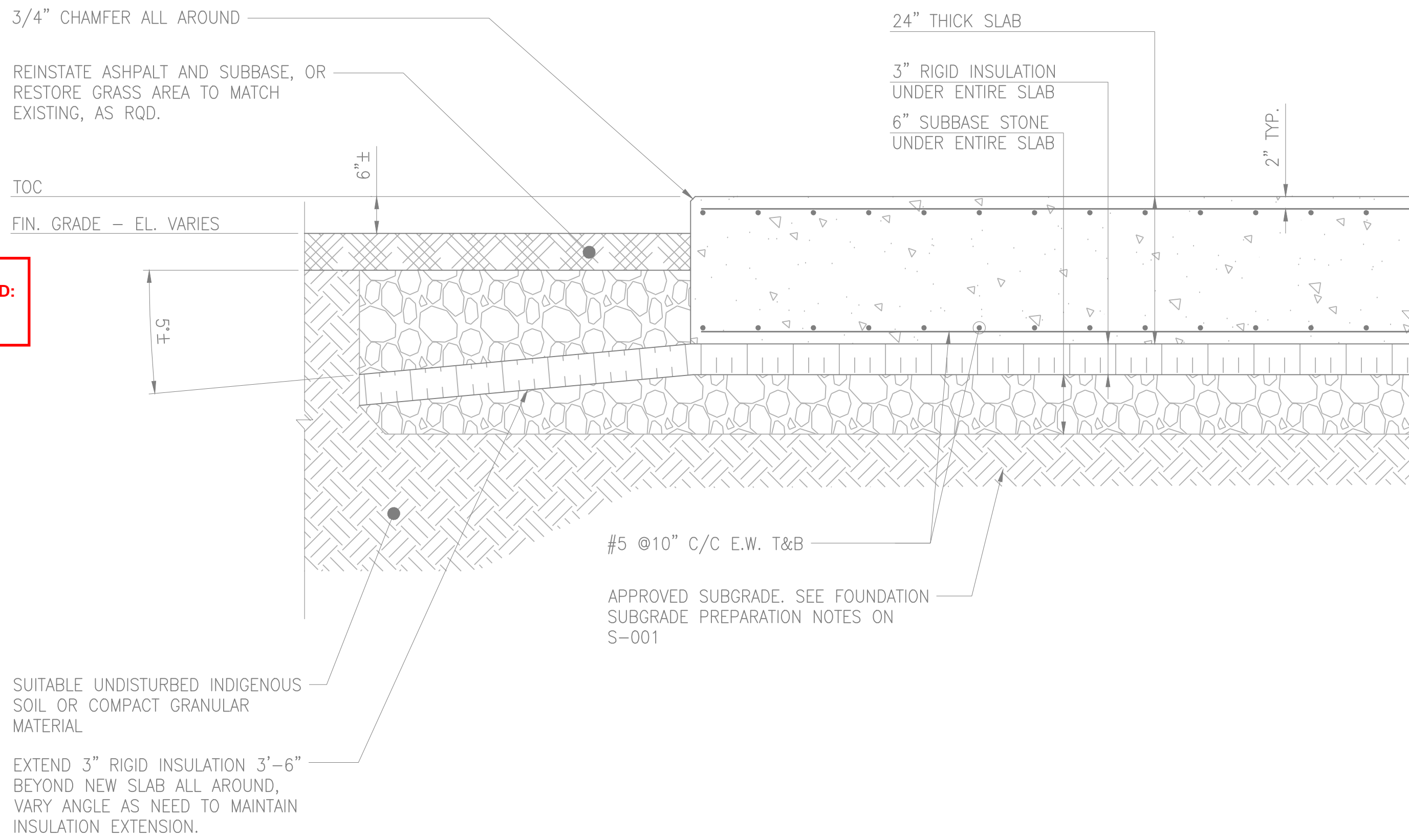
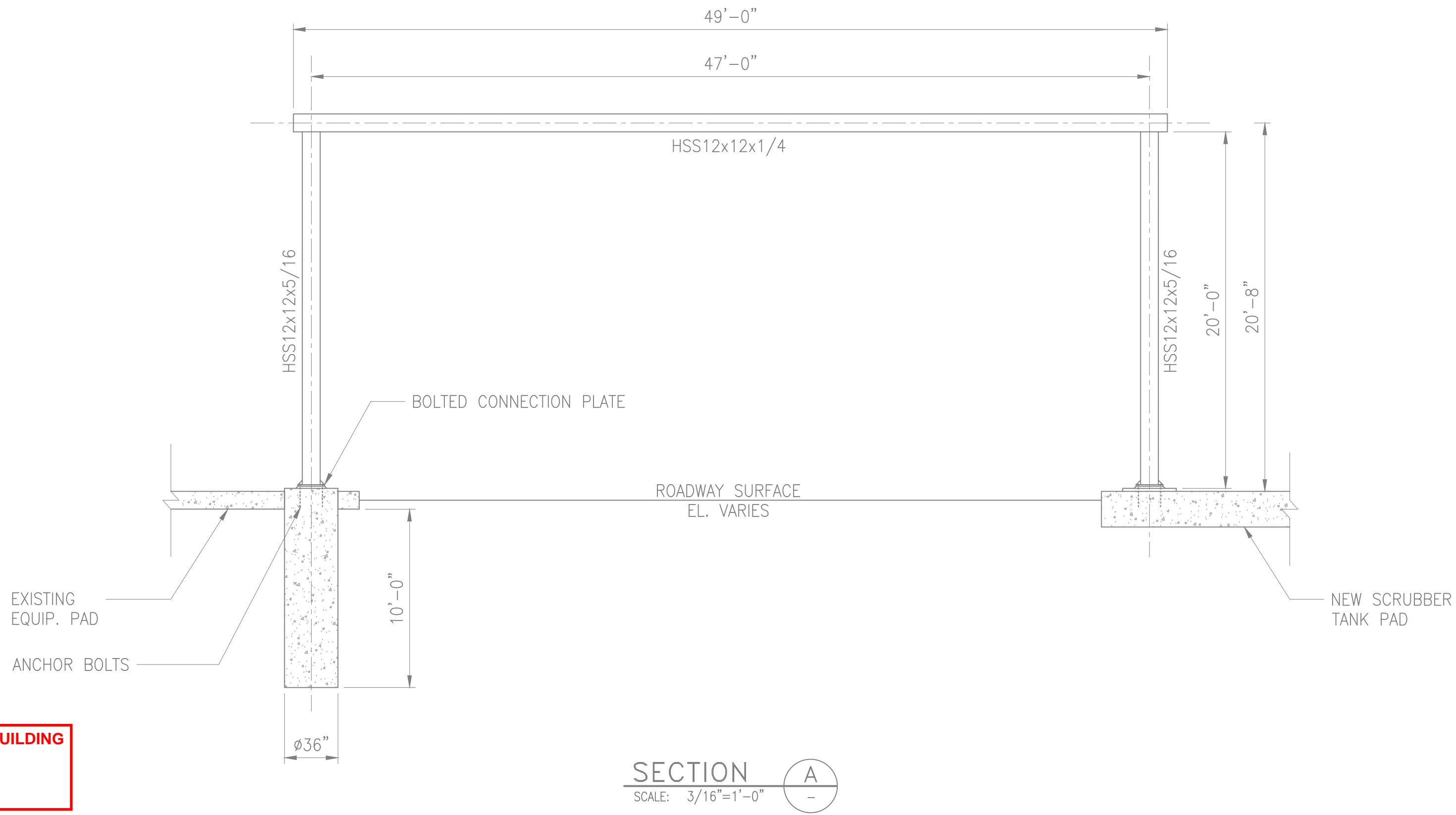

CHA

150 Baker Avenue Ext., Suite 205
Concord, MA 03343-2052
978.369.2890 • www.chacompanies.com

MARTIN

ENERGY GROUP

KEN'S

A Family Owned Company

PROFESSIONAL SEAL
TO BE APPLIED

IT IS A VIOLATION OF LAW FOR ANY PERSON, UNLESS THEY ARE ACTING UNDER THE DIRECTION OF A LICENSED PROFESSIONAL ENGINEER, ARCHITECT, LANDSCAPE ARCHITECT OR LAND SURVEYOR TO ALTER ANY ITEM IN ANY WAY IF AN ITEM BEARING THE STAMP OF A LICENSED PROFESSIONAL IS ALTERED. THE ALTERING ENGINEER, ARCHITECT, LANDSCAPE ARCHITECT OR LAND SURVEYOR SHALL STAMP THE DOCUMENT AND INCLUDE THE NOTATION "ALTERED BY" FOLLOWED BY THEIR SIGNATURE, THE DATE OF SUCH ALTERATION, AND A SPECIFIC DESCRIPTION OF THE ALTERATION.

KEN'S FOODS
1 D'ANGELO DRIVE
MARLBOROUGH, MA 01752

BIOGAS & SCRUBBER
SYSTEM UPGRADES

No.	Submittal / Revision	App'd	By	Date
1	ISSUED FOR 50% DESIGN REVIEW	JCT	ATF	12/20/19

SCRUBBER TANK AND GAS SKID LAYOUT

Designed By:	Drawn By:	Checked By:
ATF	ATF	JCT

Issue Date:	Project No:	Scale:
12/20/19	058448	VARIES

Drawing No.:

S-200



PICTURE 1 - BIOGAS OUT AT GAS SKID



PICTURE 2 - BIOGAS IN AT BUILDING

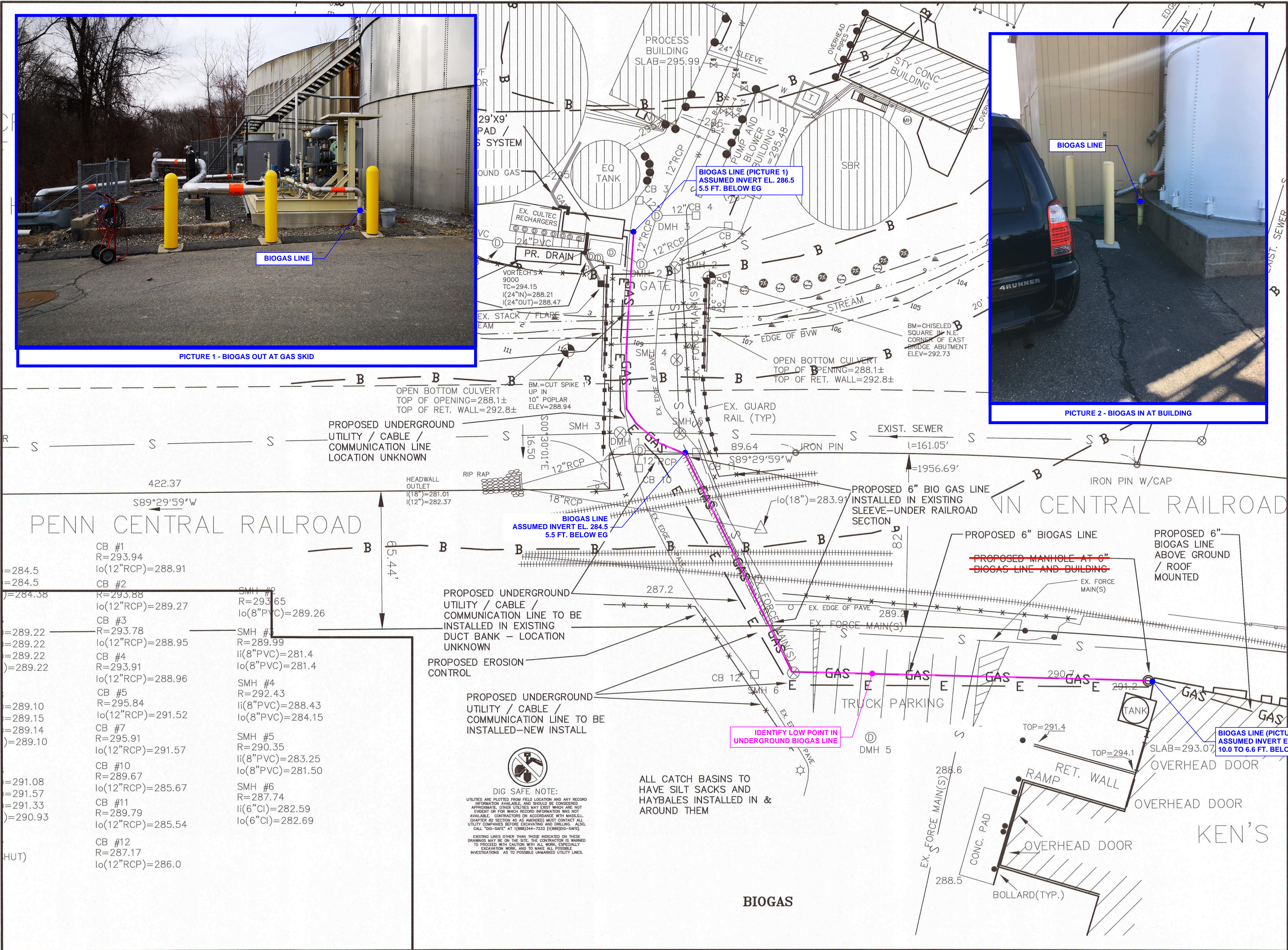

PROFESSIONAL ENGINEER DATE

NOTE: CONSTRUCTION ON THIS PROJECT IS SUBJECT TO ANY EASEMENTS, RIGHTS-OF-WAY, RESTRICTIONS, RESERVATIONS OR OTHER LIMITATIONS WHICH MAY BE REVEALED BY AN EXAMINATION OF THE TITLE.



DIG SAFE NOTE:
UTILITIES ARE PLOTTED FROM FIELD LOCATION AND ANY RECORD INFORMATION AVAILABLE, AND SHOULD BE CONSIDERED APPROXIMATE. OTHER UTILITIES MAY EXIST WHICH ARE NOT EVIDENT OR FOR WHICH RECORD INFORMATION WAS NOT AVAILABLE. CONTRACTORS (IN ACCORDANCE WITH MASS. CH. 82, SECTION 40 AS AMENDED) MUST CONTACT ALL UTILITY COMPANIES BEFORE EXCAVATING AND DRILLING. ALSO, CALL "DIG-SAFE" AT (668)344-7233 [(688)DIG-SAFE].
EXISTING LINES OTHER THAN THOSE INDICATED ON THESE DRAWINGS MAY BE ON THE SITE. THE CONTRACTOR IS WARNED TO PROCEED WITH CAUTION WITH ALL WORK, ESPECIALLY EXCAVATION WORK, AND TO MAKE ALL POSSIBLE INVESTIGATIONS AS TO POSSIBLE UNMARKED UTILITY LINES.

NOTES

- 1) 150 CEDAR HILL STREET PARCEL WAS CONVEYED BY DEED RECORDED IN BOOK 29202, PAGE 94 AND IS DEPICTED ON PLAN NO. 805 OF 1988 OF THE SOUTHERN MIDDLESEX DISTRICT REGISTRY OF DEEDS.
- 2) 1 D'ANGELO DRIVE PARCEL WAS CONVEYED BY DEED RECORDED IN BOOK 15705, PAGE 199 AND IS DEPICTED ON PLAN NO. 134 OF 1984.

LEGEND

- 000 ELEVATION CONTOUR
- UTILITY POLE
- GUY WIRE
- TREE LINE
- GUARD RAIL
- EXISTING MONITOR WELL
- EXISTING SOIL PIT
- WETLAND FLAG
- TOP OF BANK FLAG
- WETLAND BORDER
- TOP OF BROOK BANK
- WETLAND BUFFER
- EXISTING SMH
- EXISTING DMH
- EXISTING SEWER LINE

PREPARED FOR:
KEN'S FOODS INC.

OWNER:
MIP REALTY TRUST

ADDRESS:
DAR HILL ROAD
AND
ANGELO DRIVE

"BIO - GAS UTILITY"
PLAN OF LAND
IN
MARLBOROUGH, MA

SCALE: 20 FEET TO AN INCH
DATE: OCTOBER 29, 2014

REVISIONS

Guerriere & Halnon, Inc.
Engineering & Land Surveying
333 WEST STREET, MILFORD, MASS. 01757
(508) 473-6630 FAX: (508) 473-8243
www.guerriereandhalnon.com



P:\G6599\dwg\G6599 EX COND GAS 7-16-14.dwg 7/25/2014 11:23:03 AM EDT